

# Z-Wave Home Automation Solutions

Being one of the most advanced Home Automation systems to date, Z-Wave is dependable, affordable and most importantly easy to assemble without laying down expensive cables.

The whole Z-Wave Home Automation system is based around the central home controller, a Z-Wave gateway, which monitors the states of the devices around it and issues commands using a secure encrypted channel. You can issue commands to your Z-Wave gateway and control the state of your devices via your smartphone or PC using an internet connection. The Z-Wave gateway can also be set to automatically turn devices ON/OFF when a sensor is tripped.

Z-Wave devices are not only able to communicate with their associated Z-Wave gateway but also any nearby devices in the network. AC powered Z-Wave devices are also capable of forwarding commands from the Z-Wave gateway to neighboring devices, effectively increasing the range of your network and assuring its responsiveness is not only fast but also reliable. All devices displaying the Z-Wave logo are interoperable regardless of whether they were produced by the same manufacturer.

For example you can configure your Z-Wave system to automatically turn on a siren when a motion sensor is tripped. You can also configure your Z-Wave network to send you automated notifications via SMS or email and to save pictures or footage depending on which devices become tripped in your home. You can arm or disarm your system on the go with your smart phone or at home with a conveniently placed switch. You can schedule your light to turn ON and OFF depending on the time of day, your presence at home or other triggers/events. Not only does Z-Wave allow you to remotely monitor and control your home it also allows you to create unlimited scenarios to enhance your way of life. You can remotely turn on your central heating before you come home or turn off your child's night lamp when they fall asleep. The list is endless...

You don't have to build your entire home automation system in one go. You can add new devices to your Z-Wave network whenever you wish in allowing you to tailor your system to your ever-changing needs.

## FEATURES

- Door/Window, humidity, temperature and illuminance sensor in one device.
- Primarily used as dry contact Door/Window sensor, it consists of two parts, magnet and a sensor.
- New Z-Wave 500 series chip supports multichannel operation and higher data rates (9.6/40/100kbps)
- Can be used with various Z-Wave networks/controllers, regardless of the manufacturers
- Very low power consumption
- Low battery auto report LED indicator
- Over-the-air firmware updates available
- Easy installation

Thank you for choosing the VISION Z-Wave D/W Sensor 4in1 (door/window contact sensor, humidity sensor, temperature sensor, and light sensor). This sensor is a Z-Wave enabled device (interoperable, two-way RF mesh networking technology) and is fully compatible with any Z-Wave enabled network and its security framework. The VISION Z-Wave D/W Sensor 4in1 sends a Z-Wave signal when a door or window is opened/closed or there is a humidity, temperature, luminance change.

## Package Contents

- 1) VISION Z-Wave D/W Sensor 4in1
- 2) Bracket for Magnet
- 3) Magnet, Screws, Adhesive tape, 2 x AAA Batteries
- 4) Quick Installation Guide

Item	Description
RF Protocol	Z-Wave (MultiLevel Command Class)
Z-wave device type	Z-wave Sensor Alarm
Operating Voltage	2 x AAA batteries
RF Frequency	921.42Mhz AU/NZ
Operation Range	Up to 30m when no obstacles
Application	Indoor use only
Operation Temperature	-10 ° C to 60 ° C
Storage Temperature	-10 ~ 80 °C
Weight	60g
Housing	ABS

### Specifications are subject to change without further notice

The information in this document is subject to change without notice. Digital Home Systems Pty Ltd (DHS) does not make any representations or warranties (implied or otherwise) regarding the accuracy and completeness of this document and shall in no event be liable for any loss of profit or any commercial damage, including but not limited to special, incidental, consequential, or other damage.

### TRADEMARKS

All trademarks and registered trademarks are the property of their respective owners or companies.

### DHS One (1) Year Limited Warranty

Digital Home Systems Pty Ltd warrants this DHS branded hardware product against defects in materials and workmanship under normal use for period of one (1) year from the date of retail purchase by the original end user purchaser ("Warranty Period"). PLEASE NOTE: breaking security label will void the warranty.

### Terms and conditions

To see complete terms and conditions browse to [http://www.digitalhomesystems.com.au/images/stories/DHS\\_Terms\\_and\\_conditions.pdf](http://www.digitalhomesystems.com.au/images/stories/DHS_Terms_and_conditions.pdf)



## Quick Installation Guide



## VISION Z-Wave D/W Sensor 4in1

CATALOGUE NO:  
DHS-SNS-DW-VIS-04



# 1 Installation

## Mounting

Push release button to open rear cover of the multi-sensor.  
Use screws or adhesive tape to mount rear cover on the frame along the opening edge of a door/window.

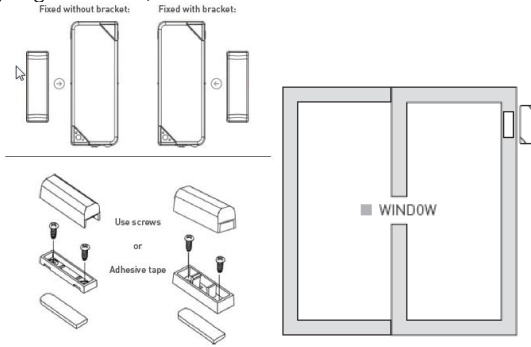

Attach the magnet to the door or window frame using screws or adhesive tape.  
Ensure that the distance between the magnet and multi-sensor is less than two centimetres when the door/window is closed.

## Include or exclude in Z-Wave network

1. Make sure your Z-Wave controller is in the right operation mode (include or exclude).
2. Press and hold the program switch for 1 second and release to start the inclusion or exclusion process (indication mode: Ready for learn mode)  
If you are using NWI include mode with your Z-Wave controller please note that this device will be NWI mode for 30 seconds after the insertion of batteries.

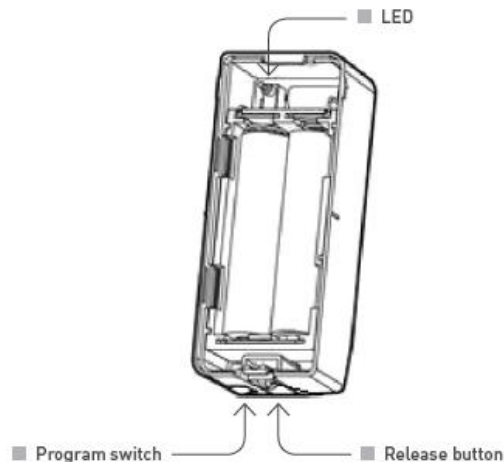

# 2 Operation

## Configuration

Parameter Number	Size	Value	Preset
1 (temperature)	1	°C	0x00
		°F	0x01
2 (temperature)	1	1~50 (set from 0.1°C ~ 5°C)	1 (°C)
3 (humidity)	1	1~50 (set from 1% ~ 50%)	10%
4 (light)	1	0/5~50 (set from 0(off) or 5% ~ 50%)	10%

## Awake Mode

Press the program switch to set this device to Awake Mode. It will notify its associated Z-Wave gateway and receive any new commands before going to sleep.

## Auto Wake Up

You can use your Z-Wave gateway to set up the amount of time this device will wait between each wake up. The default is set to 1800 seconds. Please note: reducing this will cause the battery to deplete faster.

## Low Battery Auto Report

Low battery is set as  $2.6 \pm 0.1V$  and is detected every 2 hours.

## Supporting Command Classes

Class:GENERIC\_TYPE\_SENSOR\_ALARM  
Z-Wave Lib: 4.5  
COMMAND\_CLASS\_ASSOCIATION\_GRP\_INFO  
COMMAND\_CLASS\_ASSOCIATION\_V2 COMMAND\_CLASS\_BATTERY  
COMMAND\_CLASS\_CONFIGURATION  
COMMAND\_CLASS\_DEVICE\_RESET\_LOCALLY  
COMMAND\_CLASS\_FIRMWARE\_UPDATE\_MD\_V2  
COMMAND\_CLASS\_MANUFACTURER\_SPECIFIC\_V2  
COMMAND\_CLASS\_NOTIFICATION\_V4 COMMAND\_CLASS\_POWERLEVEL  
COMMAND\_CLASS\_SECURITY COMMAND\_CLASS\_SENSOR\_MULTILEVEL\_V7  
COMMAND\_CLASS\_VERSION\_V2 COMMAND\_CLASS\_WAKE\_UP\_V2  
COMMAND\_CLASS\_ZWAVEPLUS\_INFO\_V2

# 3 Troubleshooting

**NOTE:** Before including the product to your Z-wave network it is advised to perform removal procedure to reset network settings.

## Frequently Asked Questions

- Q: I can't include my Z-Wave 4in1 D/W sensor into my Z-Wave network, what am I doing wrong?  
A1. Ensure that your Z-Wave controller is ready to include a new device by placing it into include mode.  
A2. The Z-Wave 4in1 D/W Sensor is already included in a different Z-Wave network. Exclude the Z-Wave 4in1 D/W Sensor using your Z-Wave gateway and try to include it again.  
Q: Why does the program switch on the Z-Wave 4in1 D/W Sensor not work?  
A: Check if the batteries of the Z-Wave 4in1 D/W Sensor are properly connected.

## Indication modes

The indicator gives various statuses of the device as follows:

1. Learn mode success: Indicator light blinks once.
2. Learn mode failed: Indicator light blinks five times.
3. The LED will flash once every minute or when the program switch is pressed. The color represents the current temperature according to this table:

Temperature	LED Color
Under 15°C	Green
15°C ~23°C	Blue
23°C ~28°C	Yellow
28°C ~36°C	Orange
Over 36°C	Red

## Factory Reset

Open rear cover to send alarm report then press the program switch 10 times rapidly to reset the Z-Wave 4in1 D/W Sensor.

This device is using a radio signal that passes through walls, windows and doors. The range can be influenced by local conditions such as large metal objects, house wiring, concrete, furniture, refrigerators, microwaves and similar items. On average, the indoor range is approximately 12- 30 meters.

Do not expose this product to excessive heat or moisture.  
Prevent long term exposure to direct sunlight.  
Do not attempt to repair this product. If the product is damaged or if you are in doubt about the proper operation, take the product back to the place of purchase.  
Do not clean the product with any liquid.  
Do not paint.